

DE

EN

NL

FR

IT

ES

PL

CS

SV

HOME
PILOT

Quick User Guide

Roller shutter motor classic & premium

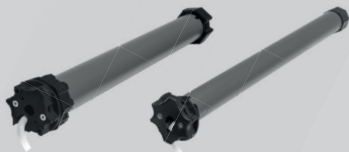

small | medium





Safety Instructions

Please observe the safety instructions prior to commissioning.



Danger of fatal electric shock



Danger area / dangerous situation



DANGER!

This hazard will result in serious injury or death.



WARNING!

This hazard can lead to serious injury or death.



CAUTION!

This hazard can cause minor to moderate injuries.



ATTENTION!

This hazard can lead to property damage.

This quick reference guide is only one part of the complete user manual. For safe handling of the product, it is necessary to read the entire manual which is available on our homepage:

<https://service.homepilot-smarthome.com>



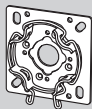
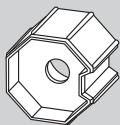
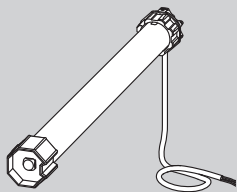



RISK OF DEATH!

Danger to life due to electric shock when touching electrical components:

- All installation and connection work must be carried out in a de-energised state!
- Disconnect all poles of the supply line from the mains and secure against reconnection.
- Check that the system is voltage-free.



DANGER!

The motor can jump out of the drive bearings if it is mounted incorrectly.

Therefore, secure the motor with the enclosed securing devices.

1

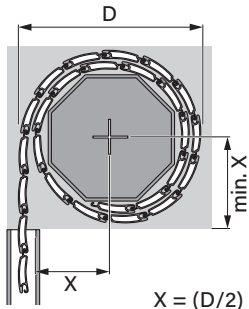

Minimum width of the roller shutter box

Motortype	Width
Small (S10)	56 cm
Medium (M10/M20/M30/M40)	67 cm

i The drive head of the motor can be installed on the right or left side of the roller shutter box. In these instructions, the installation for the right side is shown.

2



WARNING!

A roller shutter wound at an angle can block and destroy the drive, therefore install the bearings as horizontally as possible.



ATTENTION!

Mount the drive bearing so that the set button on the drive head is easily accessible later and the motor cable can be laid without kinking.

3

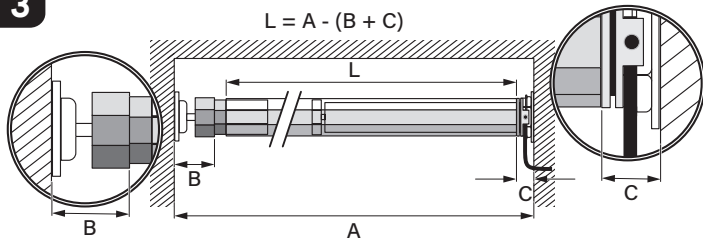

Recommendation: shorten the length of the winding shaft (L) by approx. 5 mm more than determined with the formula to ensure sufficient clearance of 2 to 3 mm in the overall length when inserting the roller capsule (4).

4

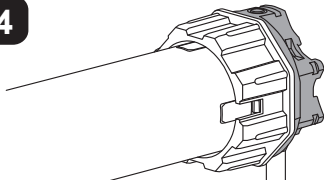

ATTENTION!

The adapter is pre-assembled by default. Make sure it is properly seated and engaged on the magnetic ring on the drive head and that the groove is in the correct position.

5

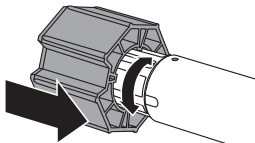

If the motor is to be operated with the self-learning end point setting and obstacle detection, then the catch must be mounted **with the freewheel mechanism** (default settings).



If the driver is to be mounted **without freewheel**, please follow the assembly steps inside the User Manual.

6

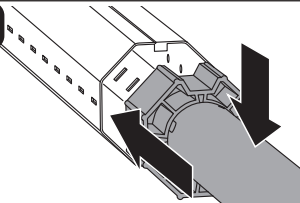

ATTENTION!

Inserting the motor forcibly into the winding shaft will destroy it. Never force the motor into the winding shaft.

7

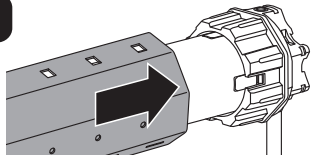

ATTENTION!

- Make sure that the adapter does not slip off the magnetic ring during assembly.
- As the length compensation is adjusted via the position of the roller capsule, push the motor completely into the winding shaft.

8

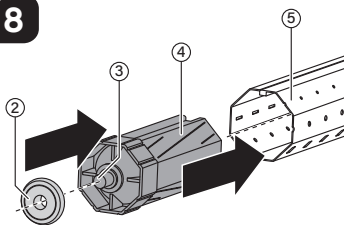

Push the roller capsule (4) into the winding shaft (5) and then place the ball bearing (2) on the axle pin (3) of the roller capsule (4).



9

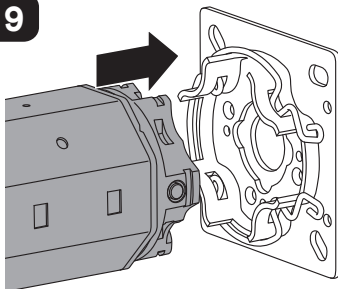

10

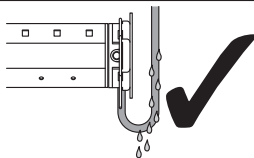
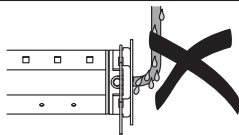

WARNING!

Danger of short-circuit due to water if the cable is routed incorrectly / damaged:

- Never lay the motor cable vertically upwards, otherwise water may run over the cable into the motor and destroy it. Lay the cable in a loop; the loop ensures that any water that runs off is collected at the lowest point and drips off.
- Lay all cables in the roller shutter box so that they cannot be damaged by moving parts.

11

Small dimensional inaccuracies may be necessary by adjusting the roller capsule, but at least 2/3 of the roller capsule's length must be inserted into the winding shaft (5). Finally, secure the roller capsule with a screw.

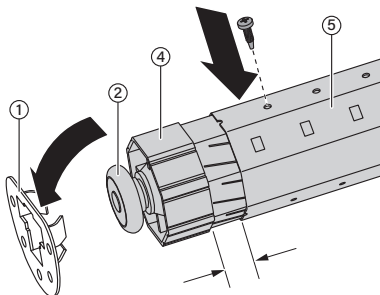

**ATTENTION!**

Drilling and inserting screws in the area of the drive will destroy the drive, therefore never drill or screw in the area of the drive to fix the roller shutter.

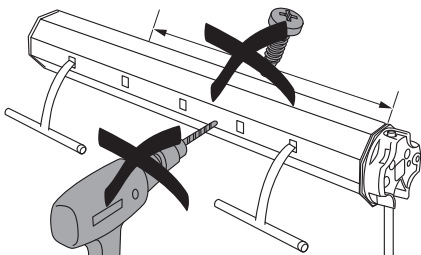
**13a** Mounting the roller shutter with rigid shaft connectors

Mount at least two rigid shaft connectors per roller shutter on both ends of the corresponding octagonal shaft. The number and type of rigid shaft connectors* may vary from the following recommendation, depending on the operating conditions.



⇒ Mount an additional rigid shaft connector every 800 mm.



Observe the information in the User Manual for shaft connectors.

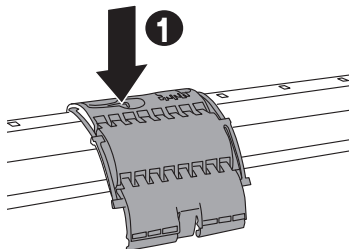

* is available as an accessory for SW 50 / SW 60 octagonal shafts in our shop

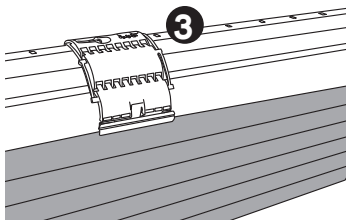
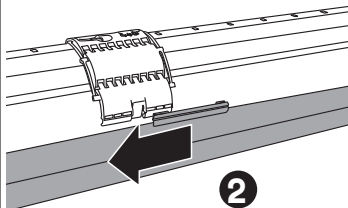

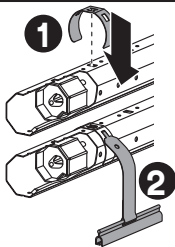
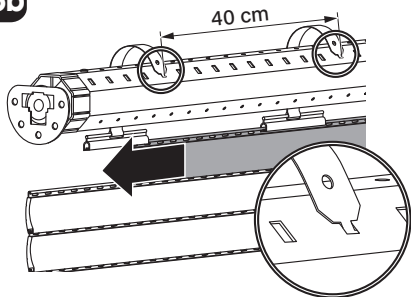
13b

For SW40 winding shafts with outer fold, use suspension clips to mount the fastening springs.

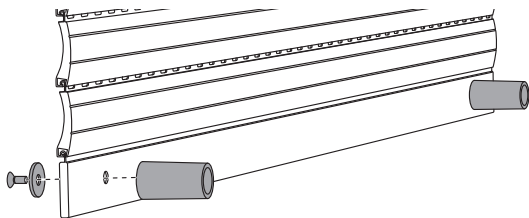
14

To use the self-learning operation, two roller shutter stoppers or an end rail must be mounted on the lowest slat/rail of the roller shutter.

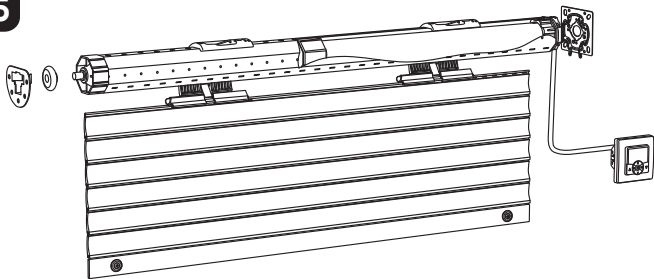
15

Electrical connection

A Motor classic

B Motor premium smart

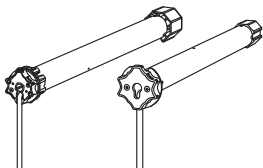

A1

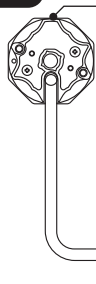

i The actual running direction of the motor and thus of the curtain (wire assignment for L1/L2) depends on the installation direction and wiring of the motor.

Set button

L1 = Running direction upwards (black)

L2 = running direction downwards (brown)

* = grey wire (without function, connect to neutral)

N = Neutral conductor (blue)

PE = earth (green/yellow)

A2

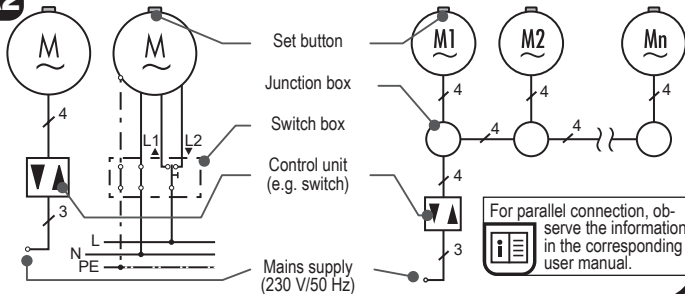

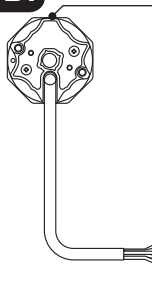
B1

- The actual running direction of the motor and thus of the curtain (wire assignment for L1/L2) depends on the installation direction and wiring of the motor.
- When shortening the connection cable, make sure that a minimum length of 20 cm is observed.



Set button

- L1 = Running direction upwards (black)
- L2 = running direction downwards (brown)
- L = continuous phase (grey)
- N = Neutral conductor (blue)
- PE = earth (green/yellow)

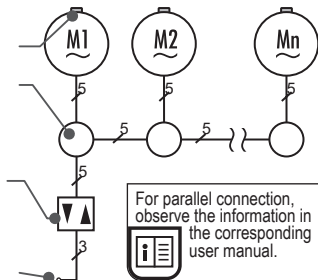
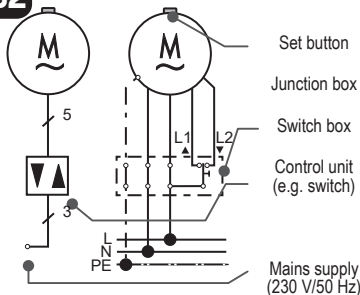
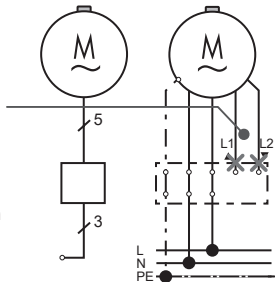
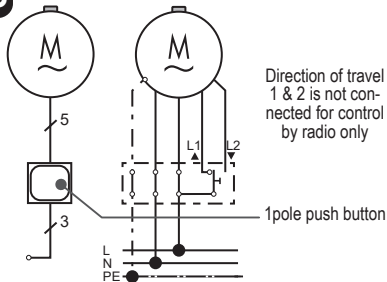
B2**B3**

1 Endpoint setting in self-learning mode



ATTENTION!

Without a stopper or end rail, the roller shutter can move into the roller shutter box during self-learning operation and be damaged. Therefore, always mount two stoppers or an end rail on the roller shutter or set end points manually according to the operating instructions.



The end points are learned automatically during the first driving cycles.

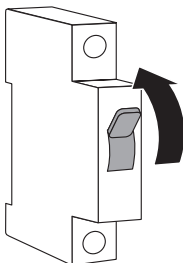

2

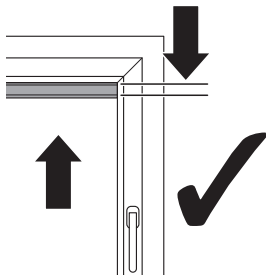

3

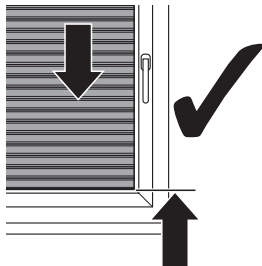

The end points can also be set manually. Further information on this as well as the complete description of the functionalities are described in the User Manual „Roller shutter motor classic“ or for the roller shutter motor premium smart“.





CONTACT

by email: service.en@homepilot-smarthome.com

DELTA DORE RADEMACHER GmbH
Buschkamp 7
46414 Rhede (Germany)